

Module Isometric View
Looking North East

Module
Looking North

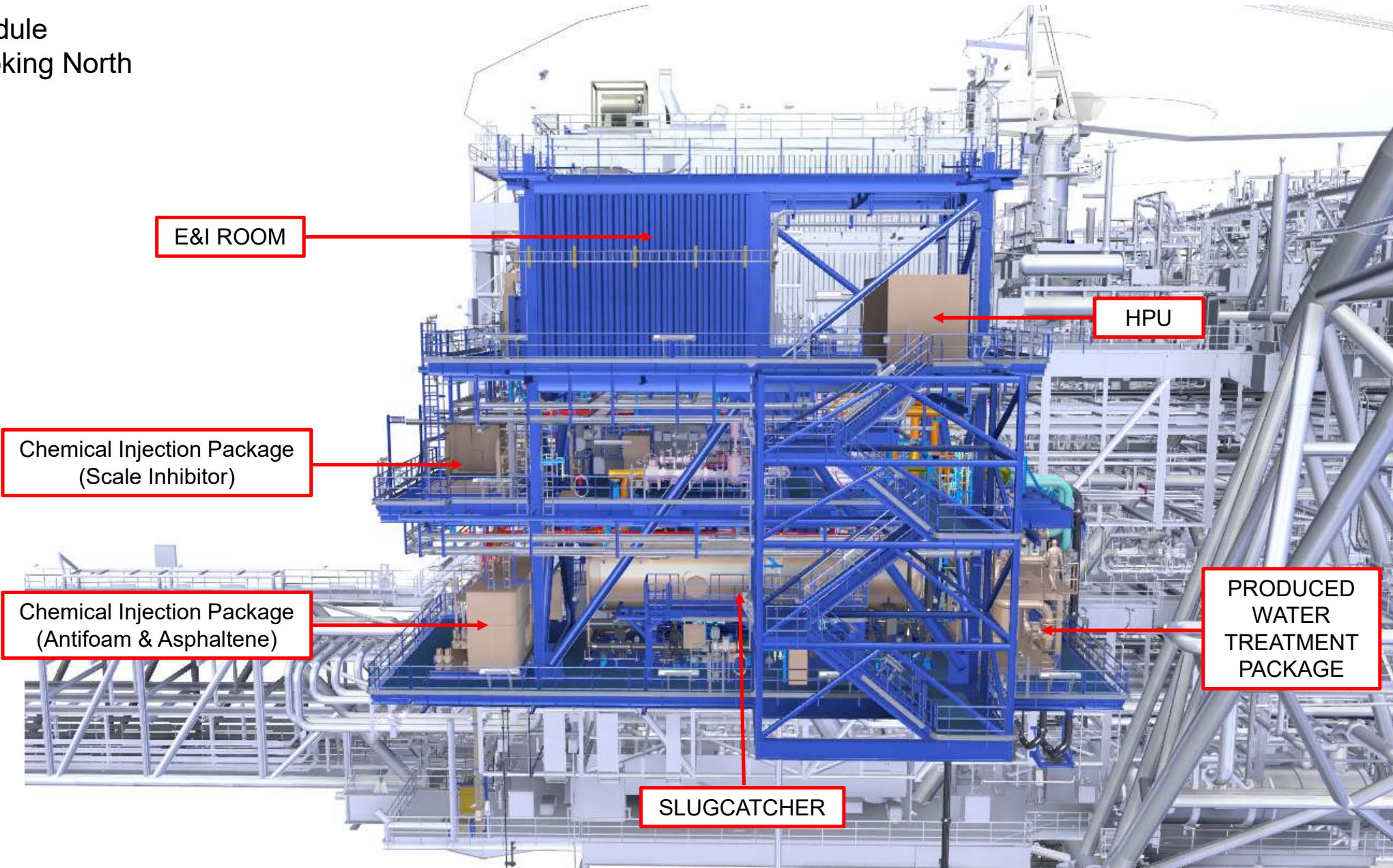

E&I ROOM

HPU

PRODUCED
WATER
TREATMENT
PACKAGE

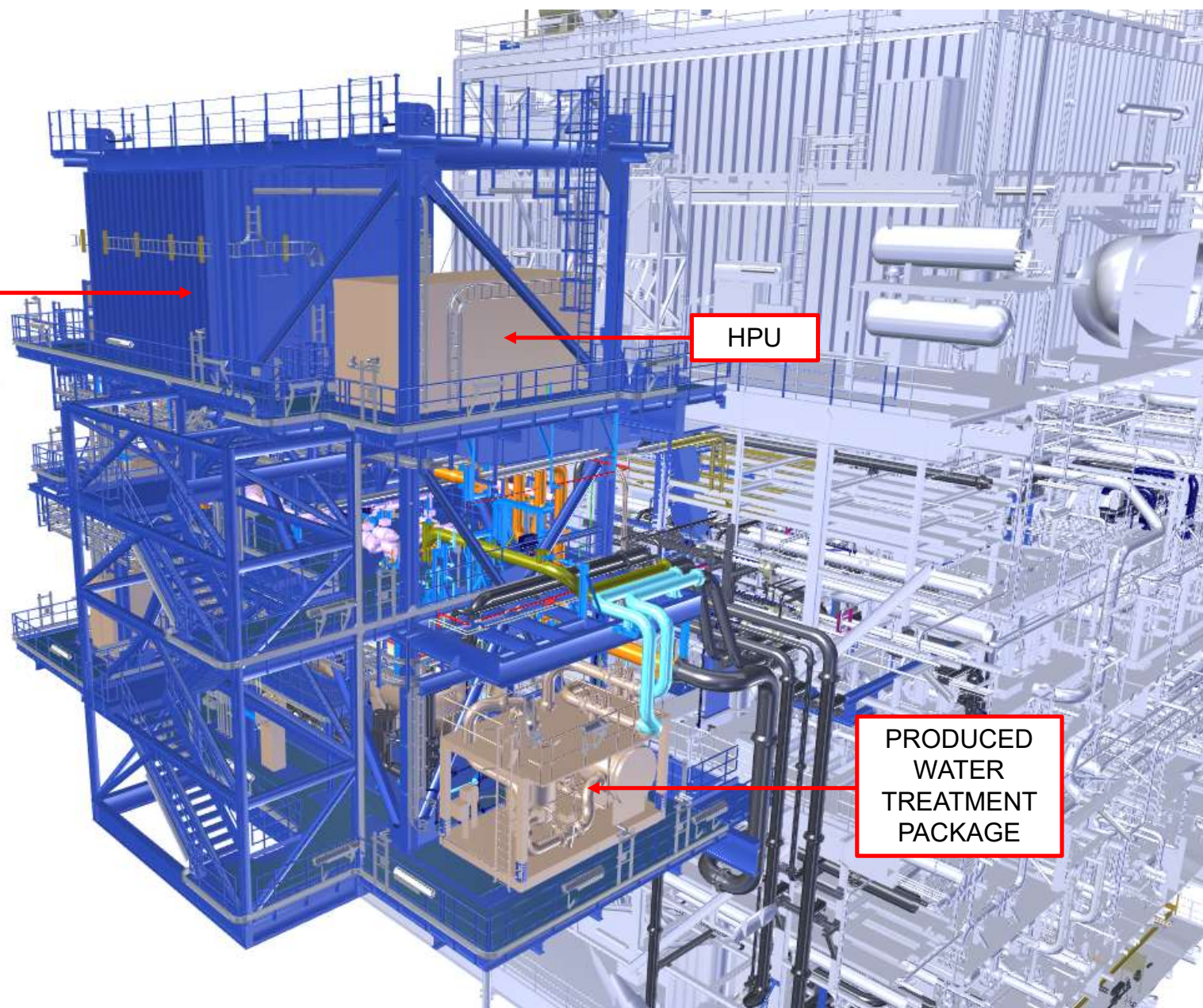

Module Isometric View
Looking North West

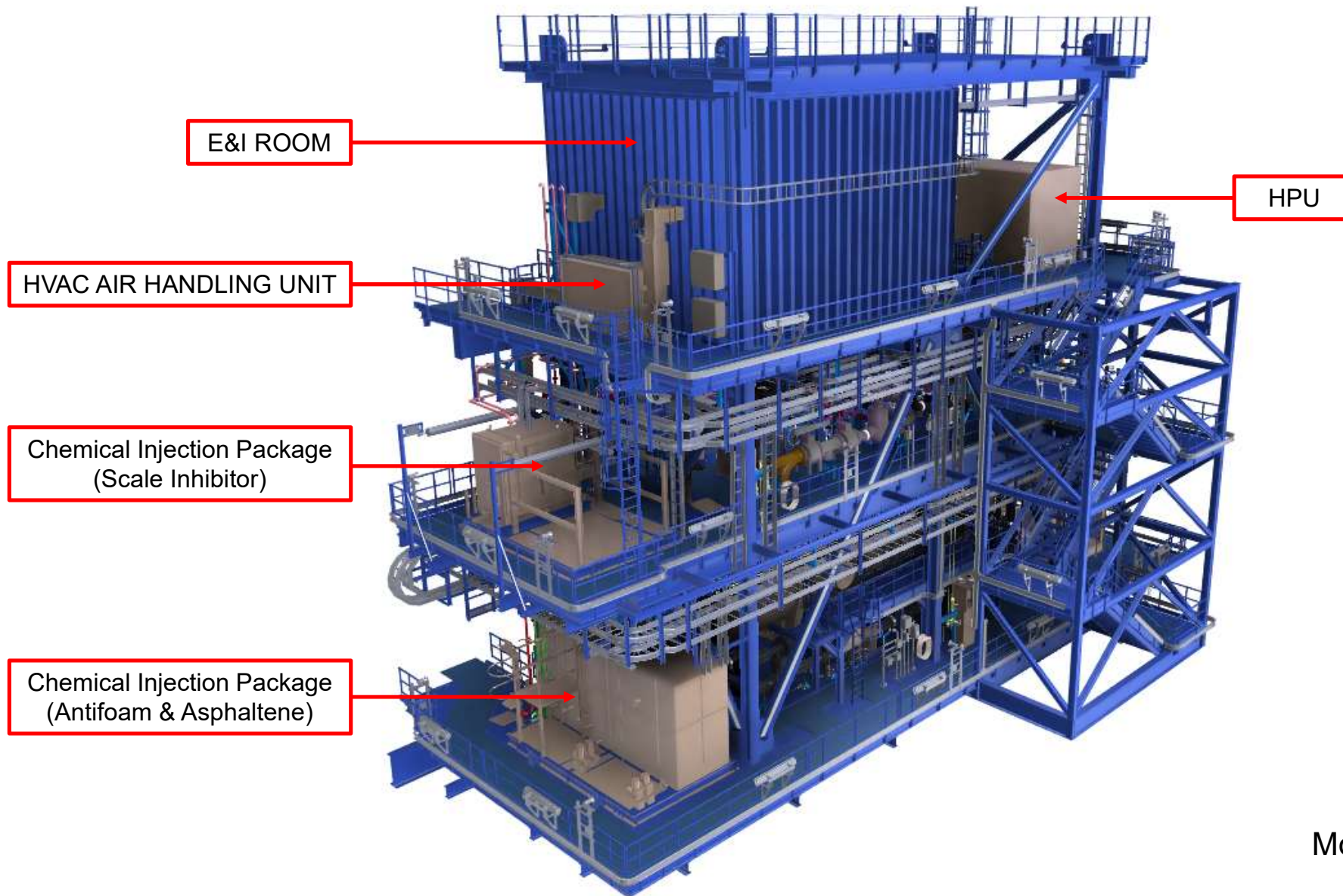

Module Isometric View
Looking North East

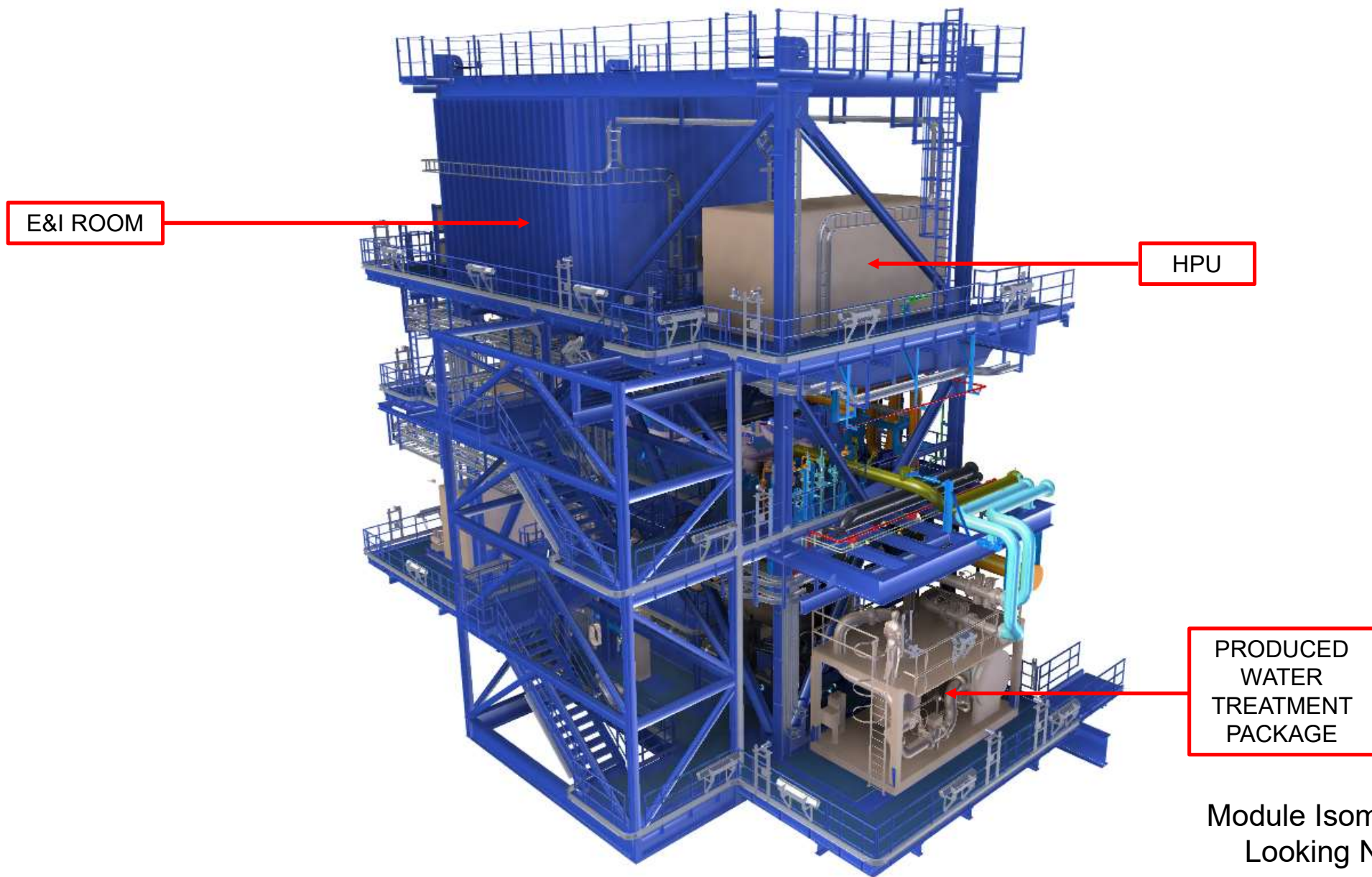

Module Isometric View
Looking North West

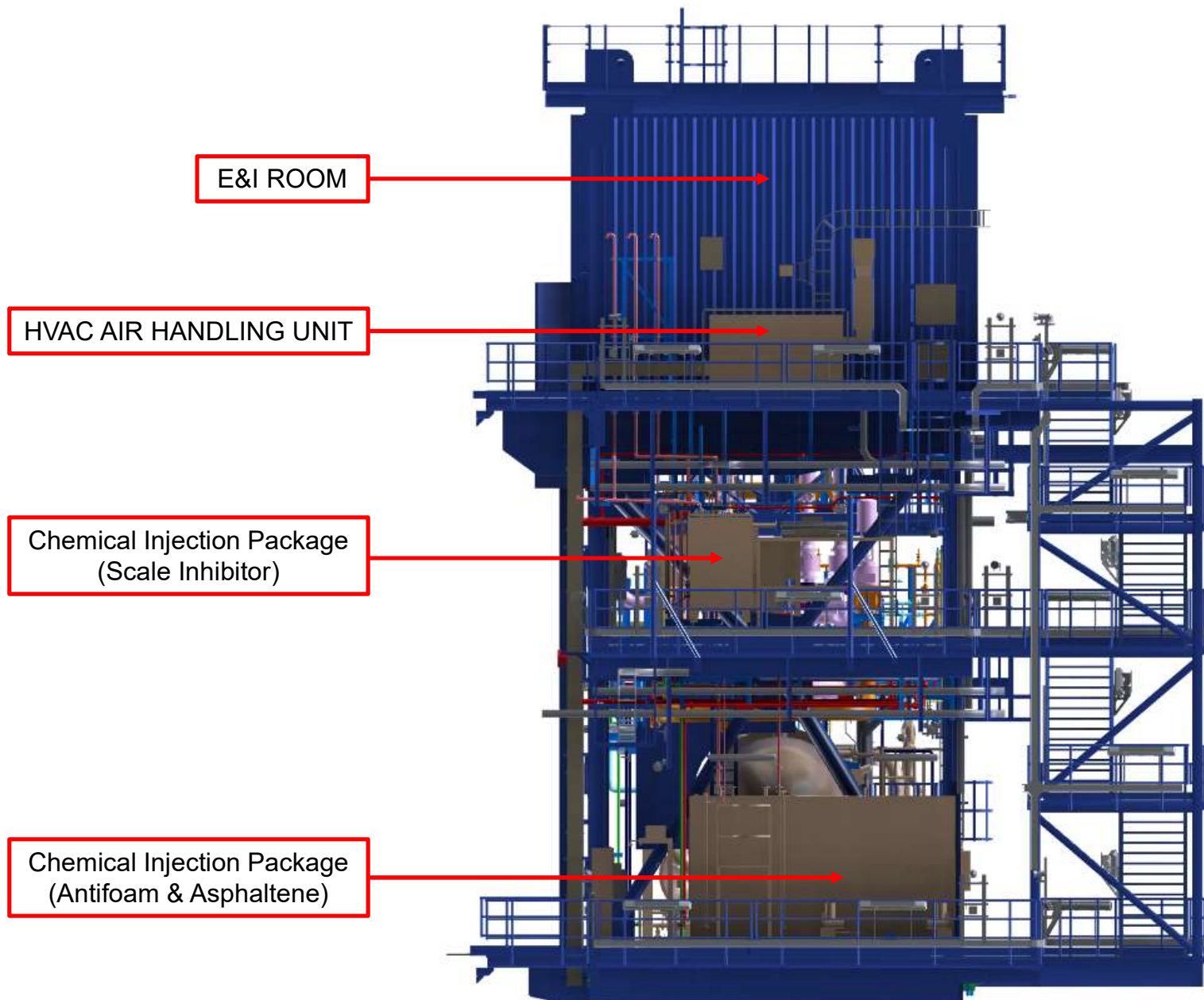

Module Ortho View
Looking East

Module Ortho View
Looking North

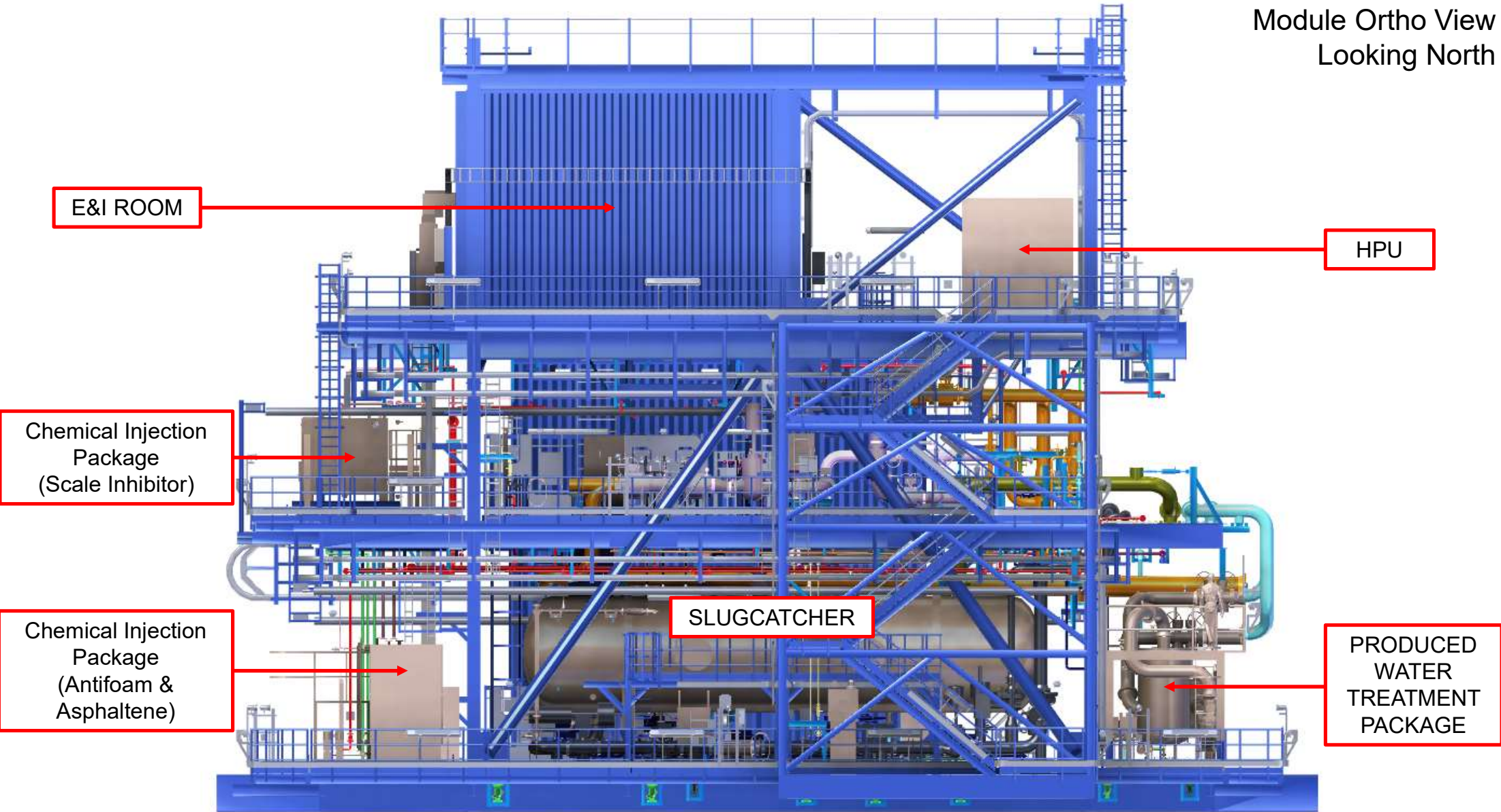

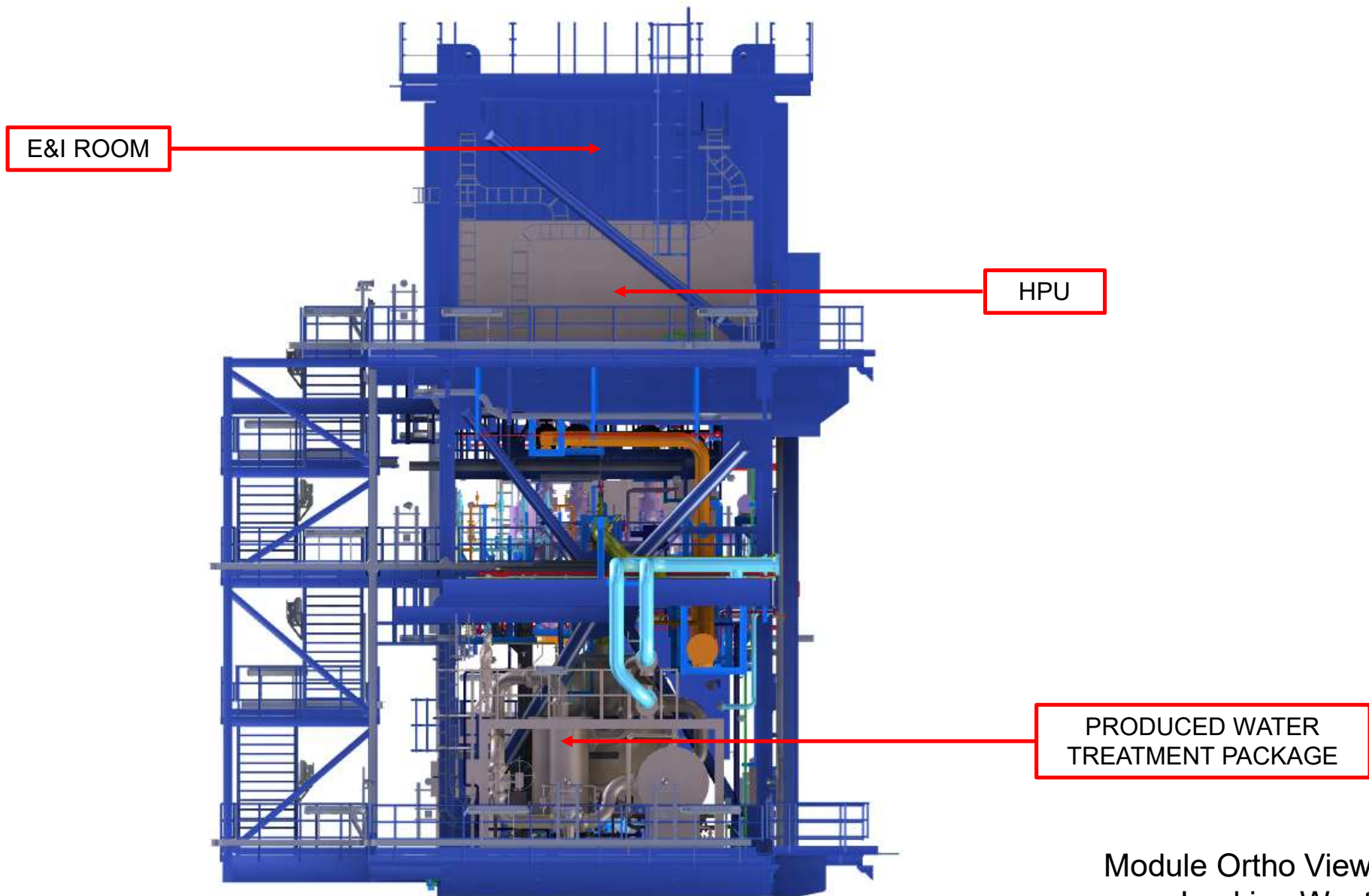

Module Ortho View
Looking West



SLUGCATCHER

A 3D CAD model of an industrial module, specifically Level 1. The structure is a complex steel framework painted blue, featuring multiple levels of walkways, ladders, and platforms. A network of green pipes is routed throughout the structure, with some sections highlighted in yellow. Three red arrows point from text labels to specific components: one to a slugcatcher, one to a chemical injection package, and one to a produced water treatment package. The entire unit is supported by a base structure.

PRODUCED
WATER
TREATMENT
PACKAGE

Chemical Injection
Package
(Antifoam &
Asphaltene)

Module Level 1 Section
Looking North East

Module Level 1 Section
Plan North

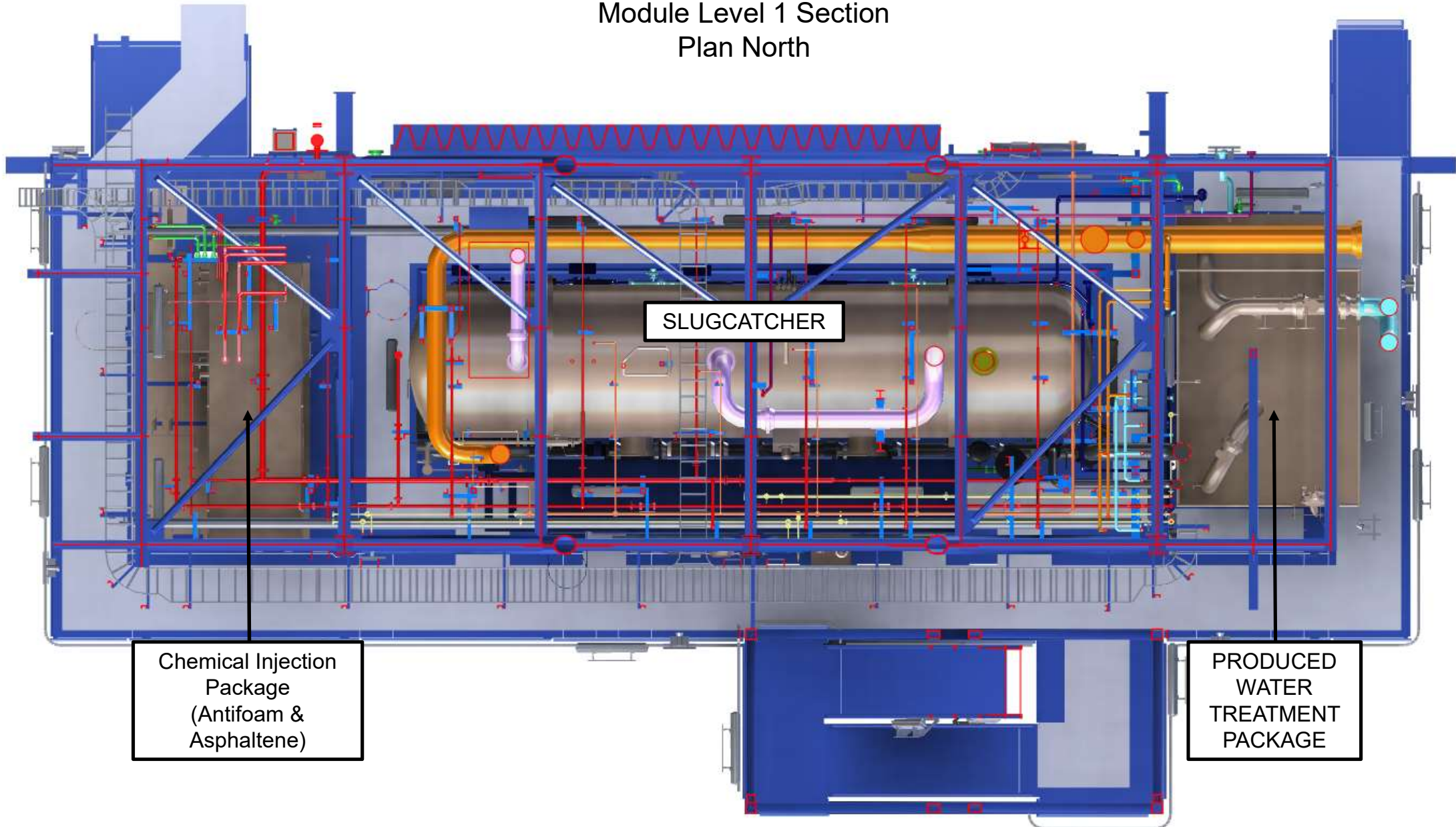

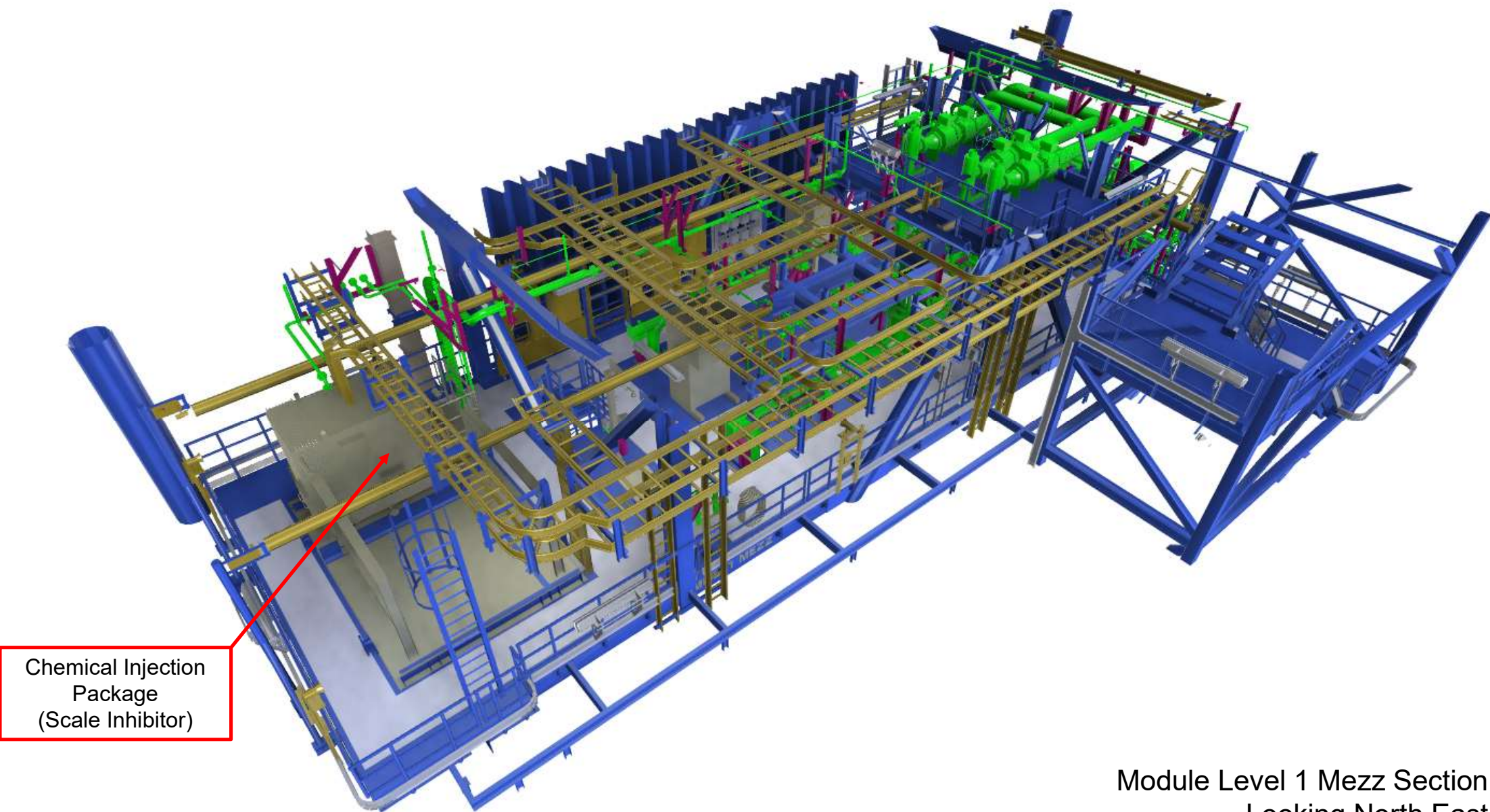

Chemical Injection
Package
(Scale Inhibitor)

Module Level 1 Mezz Section
Looking North East

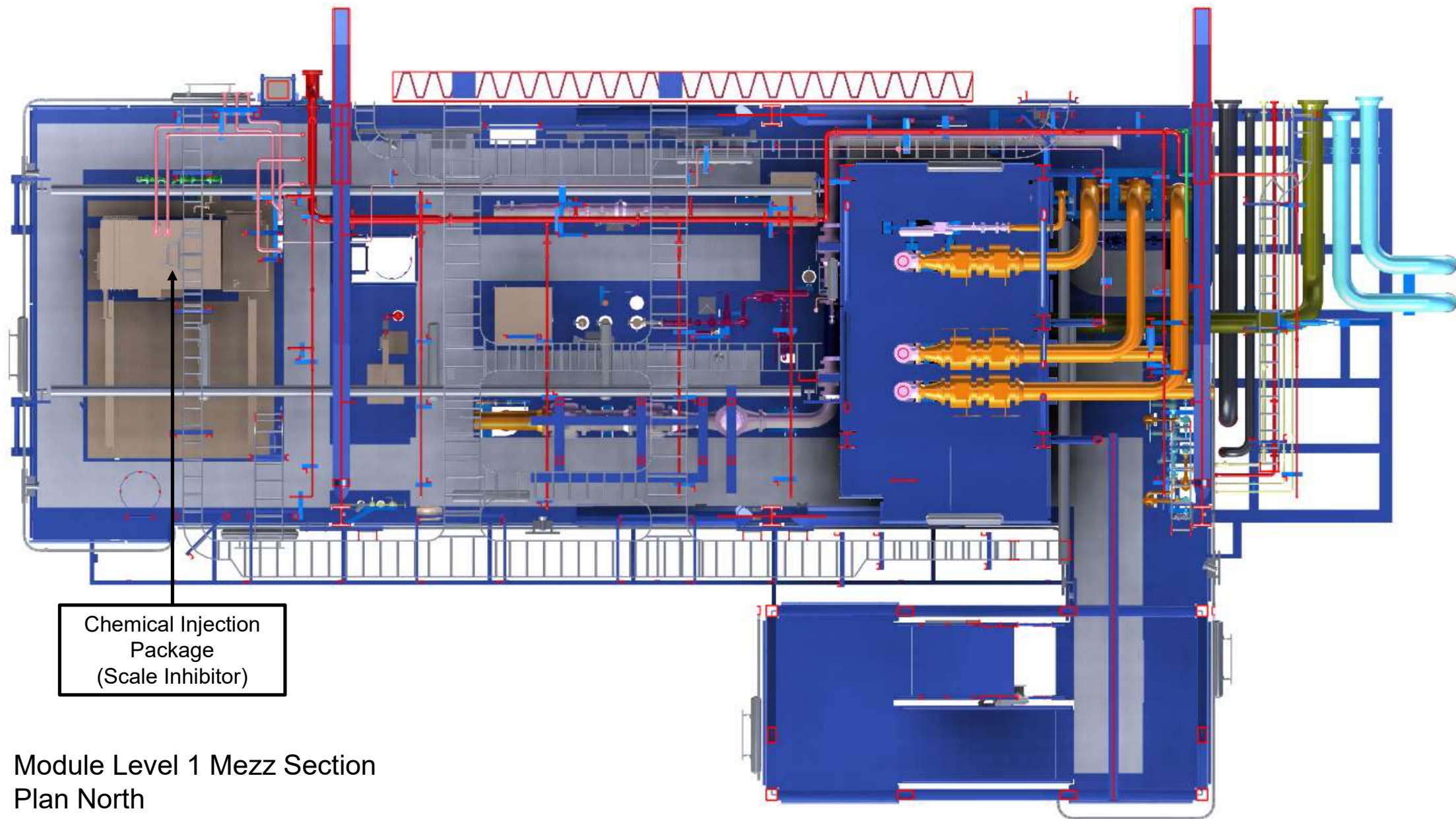

Module Level 1 Mezz Section
Plan North

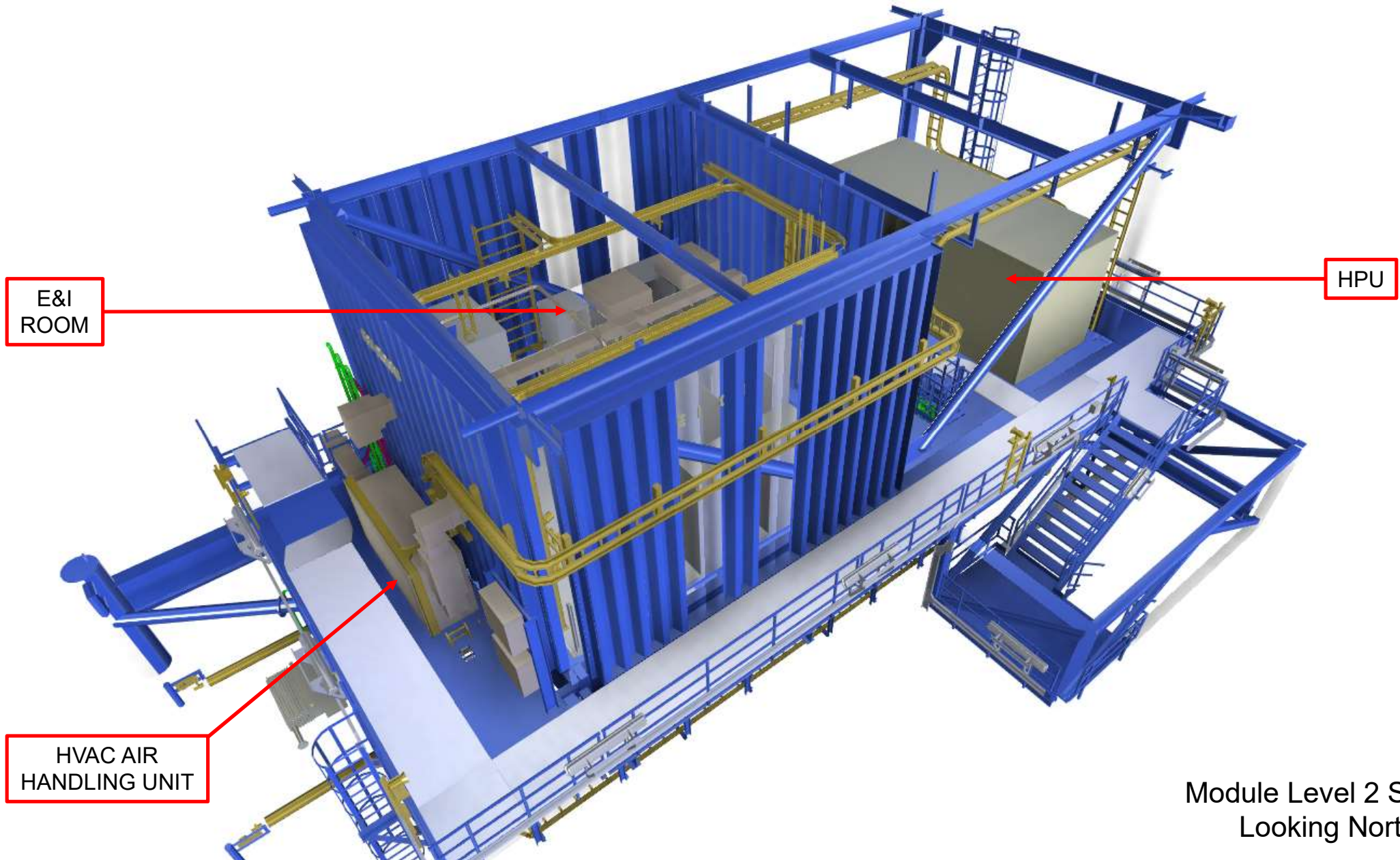

Module Level 2 Section
Looking North East

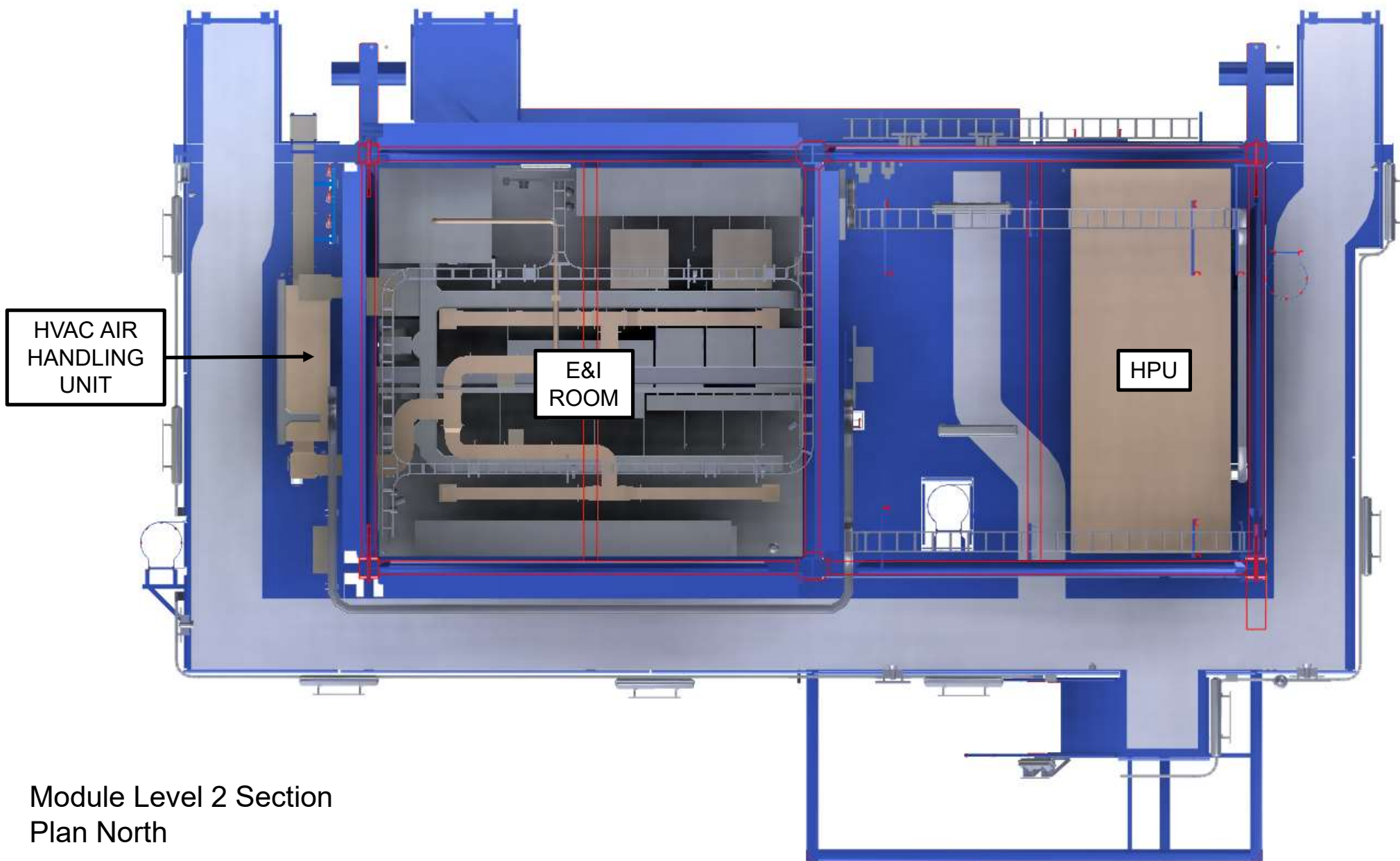

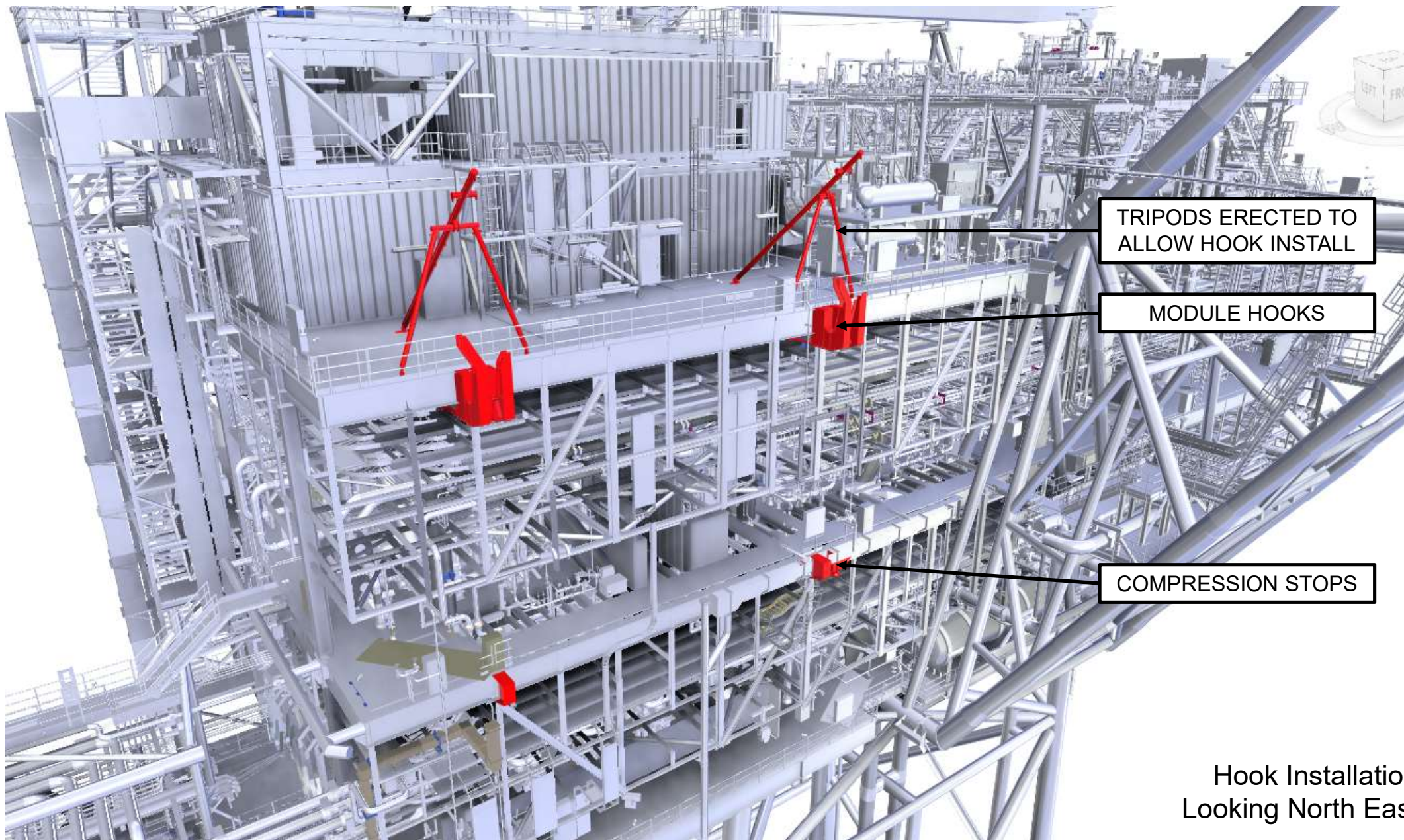

TRIPODS ERECTED TO
ALLOW HOOK INSTALL

MODULE HOOKS

COMPRESSION STOPS

Hook Installation
Looking North East

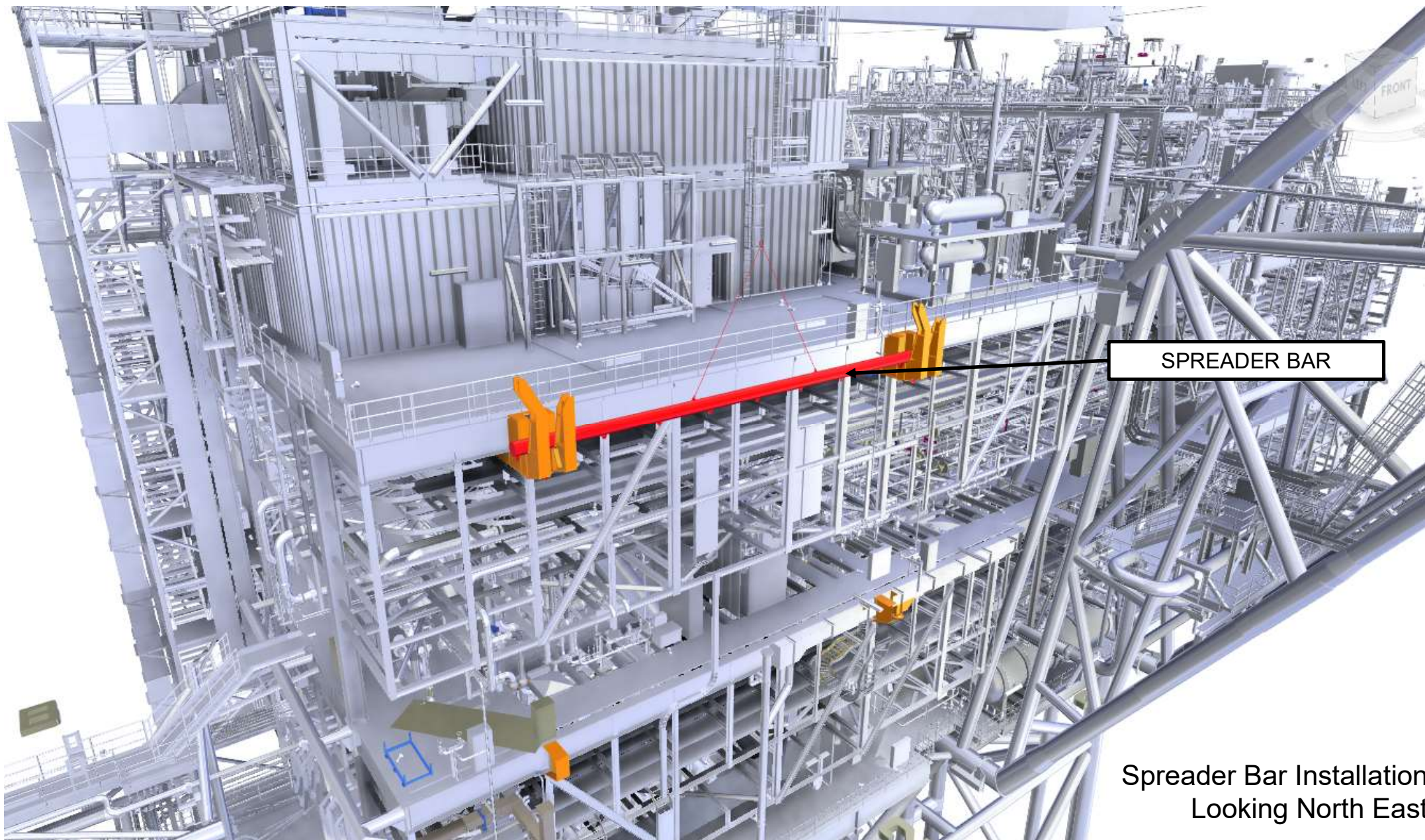

SPREADER BAR

Spreader Bar Installation
Looking North East

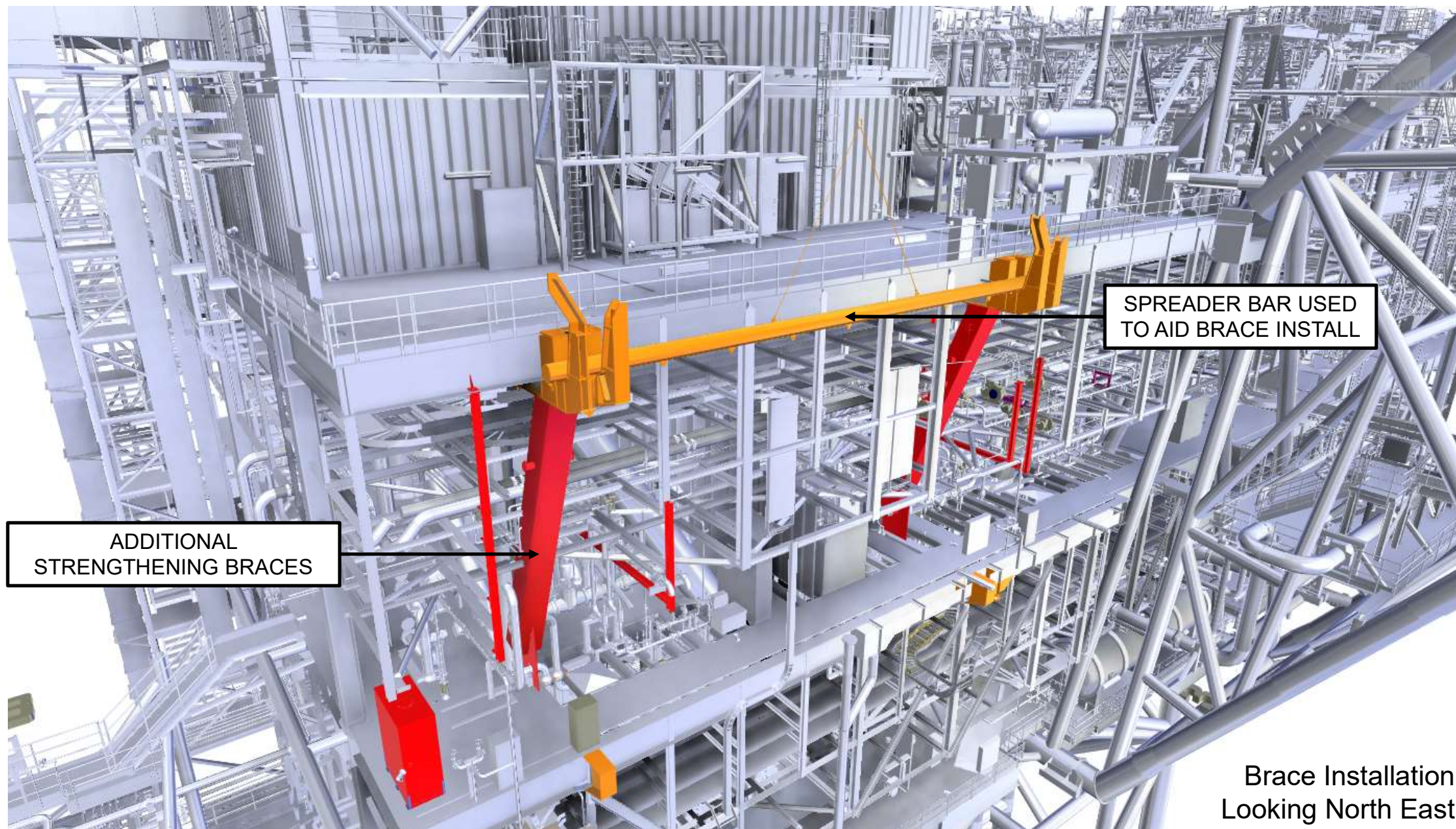

SPREADER BAR USED
TO AID BRACE INSTALL

ADDITIONAL
STRENGTHENING BRACES

Brace Installation
Looking North East



MODULE INSTALLATION
GUIDES

This 3D CAD model illustrates the proposed installation of new bumper bars and pipe rack modifications. The new structures are highlighted in red and yellow, contrasting with the existing grey industrial infrastructure. The view is from an elevated perspective looking towards the northeast. Two callout boxes with arrows point to specific components: 'MODULE INSTALLATION GUIDES' points to a horizontal red beam, and 'EXISTING PIPE RACK MODS' points to a vertical yellow support structure.

EXISTING PIPE
RACK MODS

Bumper Bars and
Pipe Rack Installation
Looking North East

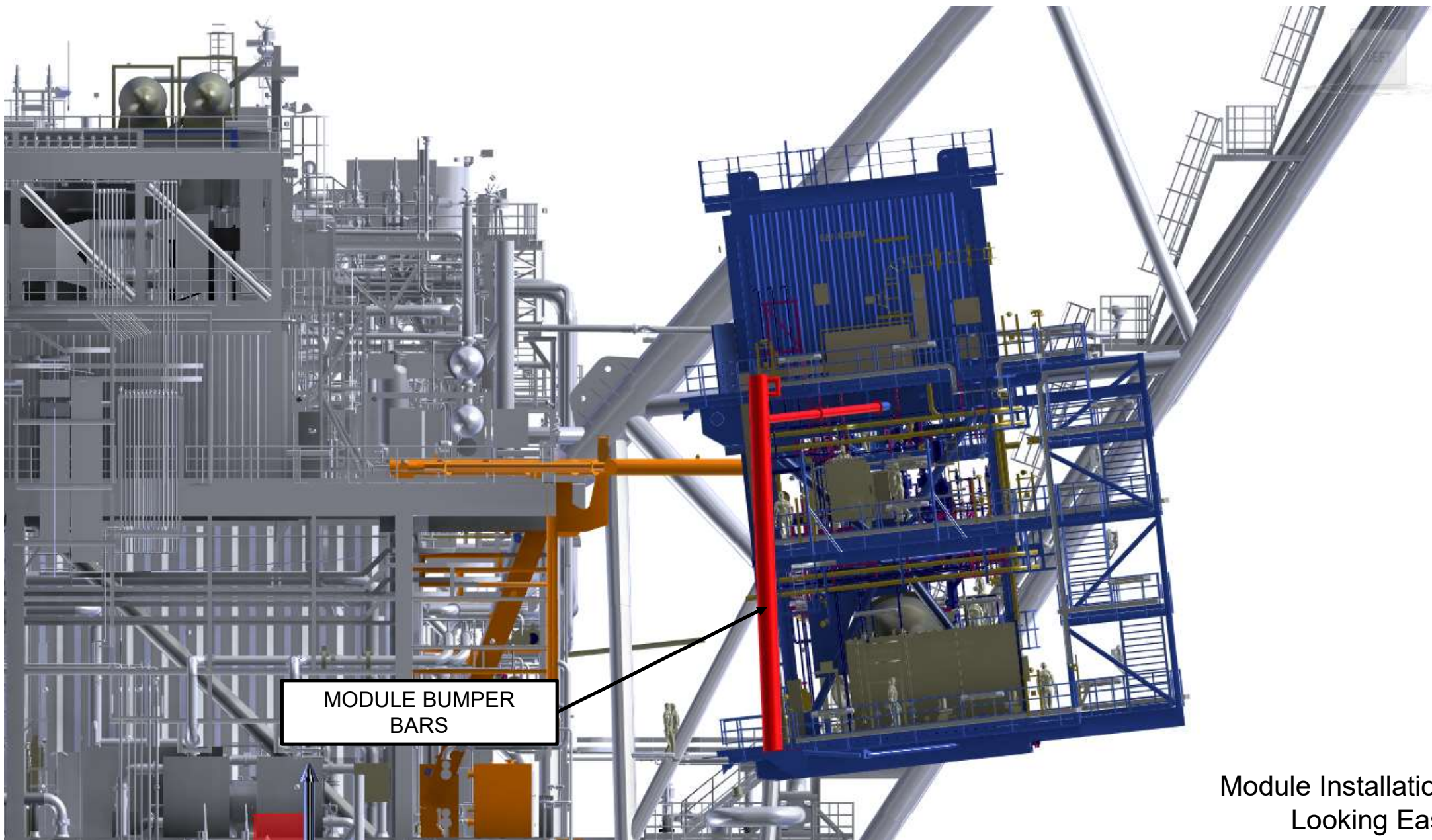

MODULE BUMPER
BARS

Module Installation
Looking East

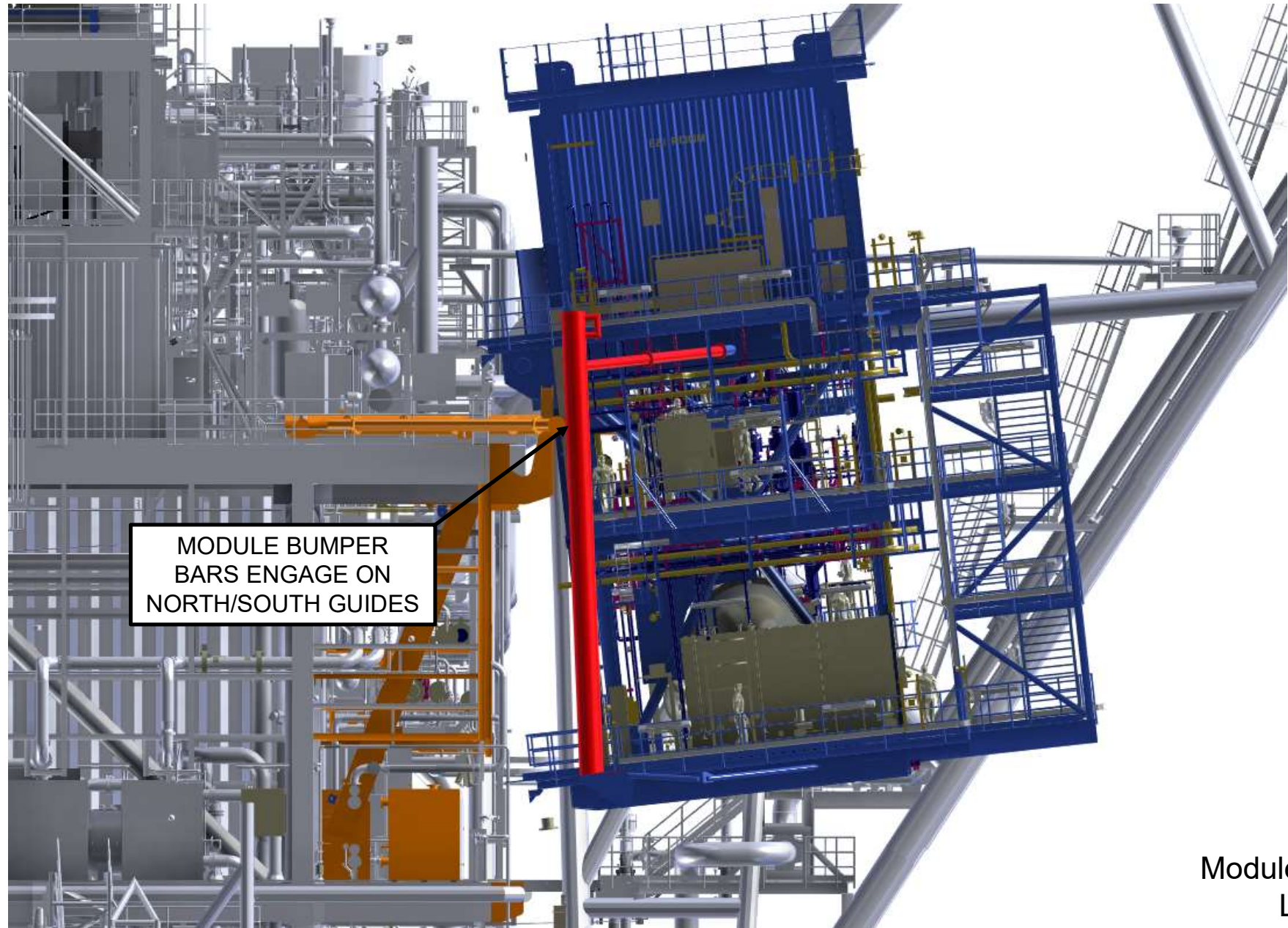

MODULE BUMPER
BARS ENGAGE ON
NORTH/SOUTH GUIDES

Module Installation
Looking East